

MANUAL NUMBER X021279 | REVISION A | ENGLISH (US)

King® E-Max™ XT™ Electric Airless Sprayer

High pressure spray packages for applying high performances coatings. For professional use only.

Not approved for use in explosive atmospheres or hazardous (classified) locations.



Important Safety Instructions

Read all warnings and instructions in this manual, in related manuals, and on the unit before using the equipment. Be familiar with the proper control and usage of the equipment. Save these instructions.

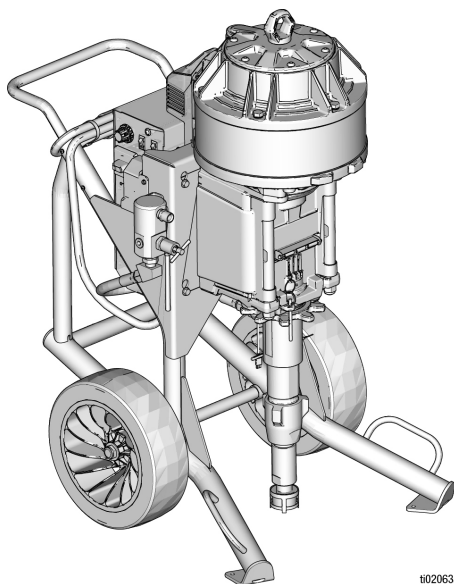

1102063a

graco.com/contact

Images are for illustrative purposes only

CONTENTS

| | |
|-----------------------------------|-----------|
| Product Information | 3 |
| Models | 3 |
| Hose Kit Models | 4 |
| Related Manuals | 5 |
| Translated Manuals | 6 |
| Link to Languages | 6 |
| Technical Specifications | 7 |
| Safety Information | 8 |
| Safety Symbols | 8 |
| General Warnings | 9 |
| Component Identification | 12 |
| Grounding | 14 |
| Power Requirements | 14 |
| Extension Cords | 14 |
| Pails | 14 |
| Pressure Relief Procedure | 15 |
| Trigger Lock | 16 |
| Setup | 17 |
| Startup | 19 |
| Operation | 21 |
| Spray Tip Installation | 21 |
| Spray | 21 |
| Clear Spray Tip Clog | 22 |
| Cleanup | 22 |
| Watchdog | 24 |
| Maintenance | 25 |
| Recycling and Disposal | 26 |
| End of Product Life | 26 |
| Troubleshooting | 27 |
| Mechanical/Fluid Flow | 27 |
| Error Code Troubleshooting | 29 |
| King E-Max XT Parts | 31 |
| California Proposition 65 | 32 |
| Graco Standard Warranty | 33 |
| graco-info | 33 |
| copyright-info | 0 |

PRODUCT INFORMATION

MODELS

Table 1-1: King E-Max XT Sprayer Models

| PART NUMBER | DESCRIPTION | VAC | GUN | HOSE (WHIP HOSE) | PRESSURE RATIO | PUMP SIZE | MAXIMUM WORKING FLUID PRESSURE |
|-------------|-------------|------|----------------|------------------------------------|----------------|-----------|--------------------------------|
| 2009100 | Bare | 230V | N/A | N/A | 40:1 | 220 cc | 4000 psi (276 bar, 27.6 MPa) |
| 2009101 | | 380V | | | | | |
| 2009106 | Complete | 230V | XTR 5+ | 3/8 in. x 50 ft (1/4 in. x 6 ft) | | | |
| 2009107 | | 380V | | | | | |
| 2009112 | | 230V | Silver Plus | 3/8 in. x 50 ft (1/4 in. x 3 ft) | | | |
| 2009113 | | 380V | | | | | |
| 2009116 | | 230V | Inline Texture | 1/2 in. x 50 ft (3/8 in. x 11 ft) | | | |
| 2009117 | | 380V | | | | | |
| 2009118 | Big 150 | 230V | XTR 5+ | 3/8 in. x 150 ft (1/4 in. x 6 ft) | | | |
| 2009119 | | 380V | | | | | |
| 2009128 | | 230V | Inline Texture | 1/2 in. x 150 ft (3/8 in. x 11 ft) | | | |
| 2009129 | | 380V | | | | | |
| 2009124 | Big 250 | 230V | Texture | 1/2 in. x 250 ft (3/8 in. x 10 ft) | | | |
| 2009125 | | 380V | | | | | |
| 2009102 | Bare | 230V | N/A | N/A | 60:1 | 180cc | 6000 psi (414 bar, 41.4 MPa) |
| 2009103 | | 380V | | | | | |
| 2009108 | Complete | 230V | XTR 7+ | 3/8 in. x 50 ft (1/4 in. x 6 ft) | | | |
| 2009109 | | 380V | | | | | |
| 2009120 | Big 150 | 230V | | 3/8 in. x 150 ft (1/4 in. x 6 ft) | | | |
| 2009121 | | 380V | | | | | |
| 2009104 | Bare | 230V | N/A | N/A | 70:1 | 145 cc | 7250 psi (500 bar, 50 MPa) |
| 2009105 | | 380V | | | | | |
| 2009110 | Complete | 230V | XTR 7+ | 3/8 in. x 50 ft (1/4 in. x 6 ft) | | | |
| 2009111 | | 380V | | | | | |

PRODUCT INFORMATION

| PART NUMBER | DESCRIPTION | VAC | GUN | HOSE (WHIP HOSE) | PRESSURE RATIO | PUMP SIZE | MAXIMUM WORKING FLUID PRESSURE |
|-------------|-------------|------|-----------|---|----------------|-----------|--------------------------------|
| 2009114 | | 230V | XHF | 1/2 in. x 50 ft (3/8 in. x 10 ft) | | | |
| 2009115 | | 380V | | | | | |
| 2009122 | Big 150 | 230V | XTR 7+ | 3/8 in. x 150 ft (1/4 in. x 6 ft) | | | |
| 2009123 | | 380V | | | | | |
| 2009126 | Big 250 | 230V | Silver HP | 3/4 in. x 200 ft, 1/2 in x 50 ft (3/8 in x 10 ft) | | | |
| 2009127 | | 380V | | | | | |

HOSE KIT MODELS

Table 1-2: Hose Kit Part Numbers and Application

| HOSE KIT PART NUMBER | APPLICATION |
|----------------------|---------------------|
| N/A | N/A |
| 2002446 | Protective Coatings |
| 287850 | Roofing |
| 2010130 | Texture |
| 2001852 | Protective Coatings |
| 2010131 | Texture |
| 16U757 | Roofing |
| N/A | N/A |
| 2002447 | Protective Coatings |
| 2001850 | |
| N/A | N/A |
| 2002447 | Protective Coatings |
| 17B824 | Roofing |
| 2001850 | Protective Coatings |
| 17B825 | Roofing |

RELATED MANUALS

| ENGLISH MANUAL NUMBER | DESCRIPTION |
|-----------------------|--|
| | Lower Manual (Pump) |
| 333507 | Hopper Installation Kit, Instructions |
| 311534 | 25 Gallon Texture Hopper, Instructions |
| 311254 | Silver Plus, Silver Plus HP, and Flex Plus™ Airless Spray Guns, Instructions |
| 3A7469 | XTR5+™ and XTR7+™ Airless Spray Gun, Instructions |
| 3A2799 | XHF™ Spray Gun, Instructions |
| 308491 | Texture Airless Spray Gun, Instructions, Parts |
| 3A2954 | VISCON® HF High Flow, High Pressure Fluid Heater, Instructions |
| 309524 | VISCON® HP High Pressure Fluid Heater, Instructions, Parts |
| 333507 | Hopper Installation Kit, Instructions |
| | Outler Filter Kit |

TRANSLATED MANUALS

Digital versions of translated manuals for this product can be found online at [www.graco.com/\[insert web page url from mktg\]](http://www.graco.com/[insert web page url from mktg]), or by scanning the QR code listed under **Link to Languages**. Available translations and their respective Graco manual numbers are listed here for reference.

Table 1-3: Translations for King® E-Max™ XT™ Operation Manual X021279

| LANGUAGE | MANUAL NUMBER |
|------------|---------------|
| Chinese | X021279ZH |
| Dutch | X021279NL |
| English | X021279EN |
| French | X021279FR |
| German | X021279DE |
| Italian | X021279IT |
| Japanese | X021279JA |
| Korean | X021279KO |
| Polish | X021279PL |
| Portuguese | X021279PT |
| Romanian | X021279RO |
| Spanish | X021279ES |
| Swedish | X021279SV |
| Turkish | X021279TR |

LINK TO LANGUAGES

To locate translated manuals online, scan the QR code and find the appropriate manual on the web page which appears.

[insert QR code from Kevin Robb]

[www.graco.com/\[insert web page url from mktg\]](http://www.graco.com/[insert web page url from mktg])

TECHNICAL SPECIFICATIONS







| KING® E-MAX™ XT™ ELECTRIC AIRLESS SPRAYERS | | |
|--|--|-------------------|
| | US | METRIC |
| Maximum fluid working pressure | | |
| 70:1 | 7250 psi (145cc) | 500 bar, 50.0 MPa |
| 60:1 | 6000 psi (180cc) | 414 bar, 41.4 MPa |
| 40:1 | 4000 psi (220cc) | 276 bar, 27.6 MPa |
| Fluid Outlet NPSM | 1/2 in. | 12.7 mm |
| Generator Minimum | 10 kW | |
| Power Requirements | 220-240V, 30 A | |
| Dimensions | | |
| Height | 45.6 in. | 115.8 cm |
| Length | 35.8 in. | 90.9 cm |
| Width | 24.2 in. | 61.5 cm |
| Weight | 400 lb. | 180 kg |
| Materials of Construction | | |
| Wetted materials on all models | zinc- and nickel-plated carbon steel, nylon, stainless steel, PTFE, acetal, leather, UHMWPE, aluminum, tungsten carbide, polyethylene, fluoroelastomer, urethane | |
| Notes | | |
| All trademarks or registered trademarks are the property of their respective owners. | | |

SAFETY INFORMATION

SAFETY SYMBOLS

The following safety symbols appear throughout this manual and on warning labels. Read the table below to understand what each symbol means.

| SYMBOL | MEANING |
|--|-----------------------------|
|  | Electric Shock Hazard |
|  | Equipment Misuse Hazard |
|  | Fire and Explosion Hazard |
|  | Moving Parts Hazard |
|  | Skin Injection Hazard |
|  | Skin Injection Hazard |
|  | Splash Hazard |
|  | Toxic Fluid or Fumes Hazard |
|  | Ground Equipment |

| SYMBOL | MEANING |
|---|--|
|  | Read Manual |
|  | Follow Pressure Relief Procedure |
|  | Ventilate Work Area |
|  | Wear Personal Protective Equipment |
|  | Eliminate Ignition Sources |
|  | Do Not Stop Leaks with Hand, Body, Glove or Rag |
|  | Do Not Place Hands or Other Body Parts Near Fluid Outlet |



Safety Alert Symbol

This symbol indicates: Attention! Become Alert! Look for this symbol throughout the manual to indicate important safety messages.

GENERAL WARNINGS

The following warnings apply throughout this manual. Read, understand, and follow the warnings before using this equipment. Failure to follow these warnings can result in serious injury.

 **WARNING**
**FIRE AND EXPLOSION HAZARD**

Flammable fumes, such as solvent and paint fumes, **in work area** can ignite or explode. Paint or solvent flowing through the equipment can cause static sparking. To help prevent fire and explosion:



- Use equipment only in well-ventilated area.
- Eliminate all ignition sources, such as pilot lights, cigarettes, portable electric lamps, and plastic drop cloths (potential static sparking).
- Ground all equipment in the work area. See **Grounding** instructions.
- Never spray or flush solvent at high pressure.
- Keep work area free of debris, including solvent, rags and gasoline.
- Do not plug or unplug power cords, or turn power or light switches on or off when flammable fumes are present.
- Use only grounded hoses.
- Hold gun firmly to side of grounded pail when triggering into pail. Do not use pail liners unless they are anti-static or conductive.
- **Stop operation immediately** if static sparking occurs or you feel a shock. Do not use equipment until you identify and correct the problem.
- Keep a working fire extinguisher in the work area.

**SKIN INJECTION HAZARD**

High-pressure fluid from gun, hose leaks, or ruptured components will pierce skin. This may look like just a cut, but it is a serious injury that can result in amputation. **Get immediate surgical treatment.**



- Do not spray without tip guard and trigger guard installed.
- Engage trigger lock when not spraying.
- Do not point gun at anyone or at any part of the body.
- Do not put your hand over the spray tip.
- Do not stop or deflect leaks with your hand, body, glove, or rag.
- Follow the **Pressure Relief Procedure** when you stop spraying and before cleaning, checking, or servicing equipment.
- Tighten all fluid connections before operating the equipment.
- Check hoses and couplings daily. Replace worn or damaged parts immediately.



WARNING



EQUIPMENT MISUSE HAZARD

Misuse can cause death or serious injury.



- Do not operate the unit when fatigued or under the influence of drugs or alcohol.
- Do not exceed the maximum working pressure or temperature rating of the lowest rated system component. See **Technical Specifications** in all equipment manuals.
- Use fluids and solvents that are compatible with equipment wetted parts. See **Technical Specifications** in all equipment manuals. Read fluid and solvent manufacturer's warnings. For complete information about your material, request Safety Data Sheets (SDSs) from distributor or retailer.
- Do not leave the work area while equipment is energized or under pressure.
- Turn off all equipment and follow the **Pressure Relief Procedure** when equipment is not in use.
- Check equipment daily. Repair or replace worn or damaged parts immediately with genuine manufacturer's replacement parts only.
- Do not alter or modify equipment. Alterations or modifications may void agency approvals and create safety hazards.
- Make sure all equipment is rated and approved for the environment in which you are using it.
- Use equipment only for its intended purpose. Call your distributor for information.
- Route hoses and cables away from traffic areas, sharp edges, moving parts, and hot surfaces.
- Do not kink or over bend hoses or use hoses to pull equipment.
- Keep children and animals away from work area.
- Comply with all applicable safety regulations.



ELECTRIC SHOCK HAZARD

This equipment must be grounded. Improper grounding, setup, or usage of the system can cause electric shock.



- Turn off and disconnect power cord before servicing equipment.
- Connect only to grounded electrical outlets.
- Use only 3-wire extension cords.
- Ensure ground prongs are intact on power and extension cords.
- Do not expose to rain. Store indoors.
- Wait five minutes after disconnecting power cord before servicing.
- Only use an authorized service center to replace a damaged power cord.



WARNING



PRESSURIZED ALUMINUM PARTS HAZARD

Use of fluids that are incompatible with aluminum in pressurized equipment can cause serious chemical reaction and equipment rupture. Failure to follow this warning can result in death, serious injury, or property damage.

- Do not use 1,1,1-trichloroethane, methylene chloride, other halogenated hydrocarbon solvents or fluids containing such solvents.
- Do not use chlorine bleach.
- Many other fluids may contain chemicals that can react with aluminum. Contact your material supplier for compatibility.



MOVING PARTS HAZARD

Moving parts can pinch, cut or amputate fingers and other body parts.



- Keep clear of moving parts.
- Do not operate equipment with protective guards or covers removed.
- Equipment can start without warning. Before checking, moving, or servicing equipment, follow the **Pressure Relief Procedure** and disconnect all power sources.



TOXIC FLUID OR FUMES HAZARD

Toxic fluids or fumes can cause serious injury or death if splashed in the eyes or on skin, inhaled, or swallowed.

- Read Safety Data Sheets (SDSs) to know the specific hazards of the fluids you are using.
- Store hazardous fluid in approved containers, and dispose of it according to applicable guidelines.



PERSONAL PROTECTIVE EQUIPMENT

Wear appropriate protective equipment when in the work area to help prevent serious injury, including eye injury, hearing loss, inhalation of toxic fumes, and burns. Protective equipment includes but is not limited to:

- Protective eyewear, and hearing protection.
- Respirators, protective clothing, and gloves as recommended by the fluid and solvent manufacturer.

This exploded view diagram illustrates the components of a Stihl chainsaw, labeled with letters A through T. The main assembly includes the engine (D), cylinder head (K), carburetor (S), air filter (C), and fuel tank (U). The guide bar (P) is shown attached to the chain drive sprocket (Q). The chain (J) is shown in a coiled state. The trigger gun (H) is shown with its trigger (G), safety switch (L), and trigger lever (F). The chain brake (N) is shown with its lever (T). The diagram also shows the chain sprocket (M) and the guide bar (P) with its mounting bracket (R). The callout letters are: A (Fuel tank), B (Fuel tank cap), C (Air filter), D (Engine), E (Fuel tank cap), F (Trigger lever), G (Trigger), H (Trigger gun), I (Chain), J (Chain), K (Cylinder head), L (Safety switch), M (Chain sprocket), N (Chain brake), O (Chain sprocket), P (Guide bar), Q (Chain drive sprocket), R (Guide bar mounting bracket), S (Carburetor), T (Chain brake lever), U (Fuel tank).

COMPONENT IDENTIFICATION

| | |
|---|-------------------------------|
| A | ON/OFF Switch |
| B | Pressure Control |
| C | LED Indicator |
| D | Lift Ring |
| E | Filter/Manifold |
| F | Tip Guard |
| G | Spray Tip |
| H | Gun |
| J | Airless Hose |
| K | Power Cord |
| L | Trigger Lock |
| M | Fluid Drain/Purge Valve |
| N | Direct Immersion Fluid Intake |
| P | Pump |
| R | Finger Guard/TSL Fill Point |
| S | Fluid Outlet |
| T | WatchDog™ Switch |
| U | Suction Tube |

| | | | | |
|--|---|---|--|--|
|  WARNING | | | | |
|  |  |  | | |
| <p>The equipment must be grounded to reduce the risk of static sparking and electric shock. An electric or static spark can cause fumes to ignite or explode. An improper ground can cause electric shock. A good ground provides an escape wire for the electric current.</p> | | | | |

PRESSURE RELIEF PROCEDURE



Follow the Pressure Relief Procedure whenever you see this symbol.

WARNING

1. Engage the Trigger Lock.

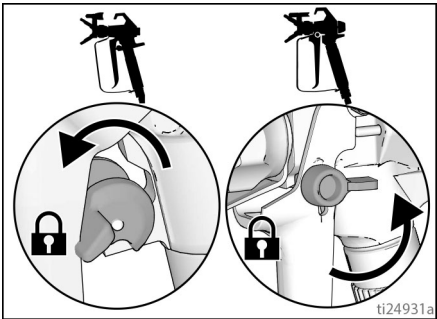

2. Turn ON/OFF switch to the **OFF** position.

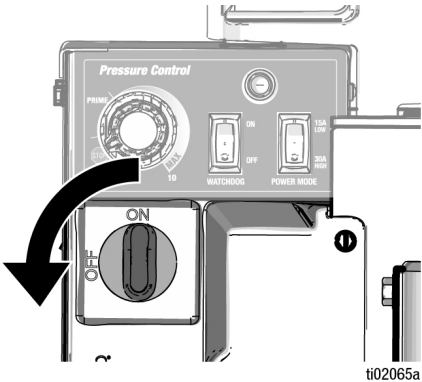

3. Turn Pressure Control knob **OFF**, or **PARK** for long term storage. In **PARK**, pump will cycle until reaching the bottom of the stroke.



4. Hold a metal part of the spray gun firmly to a grounded metal pail. Point spray gun into pail. Disengage the trigger lock and trigger the spray gun to relieve pressure.

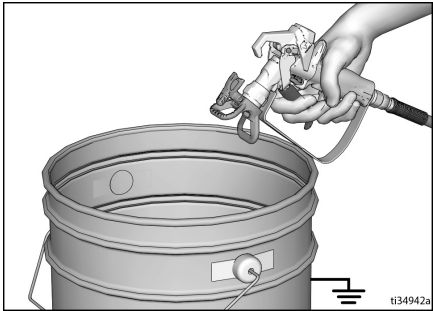

5. Engage the Trigger Lock.

PRESSURE RELIEF PROCEDURE

6. Drain fluid. To drain fluid, slowly open Fluid Drain/Purge Valve into a waste pail. Close valve after fluid is drained.

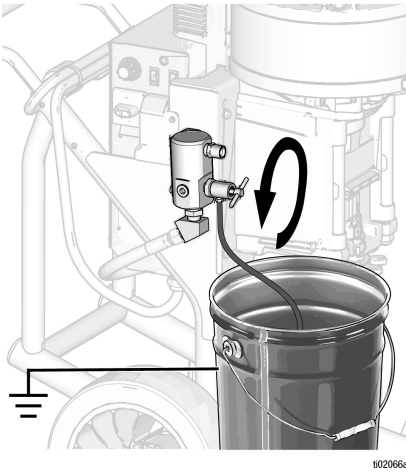

7. If you suspect the Spray Tip or hose is clogged or that pressure has not been fully relieved:
 - a. Using a wrench, VERY SLOWLY loosen the tip guard retaining nut or the hose end coupling to relieve pressure gradually.
 - b. Using a wrench, loosen the nut or coupling completely.
 - c. Clear hose or tip obstruction.

TRIGGER LOCK

Always engage the trigger lock when sprayer is stopped to prevent the gun from being triggered accidentally by hand or if dropped or bumped.

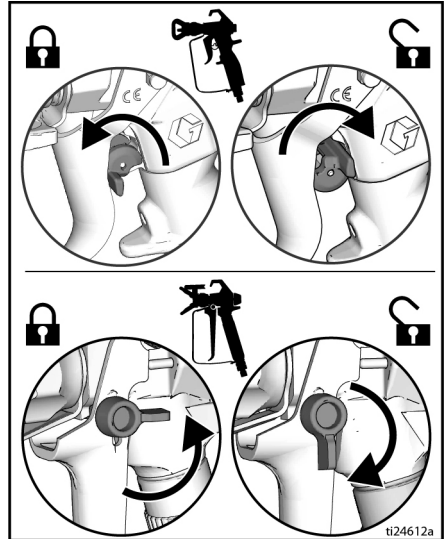

SETUP



When unpacking sprayer for the first time or after long term storage, perform setup procedure.

1. Connect Graco airless hose to fluid outlet. Use wrenches to tighten securely

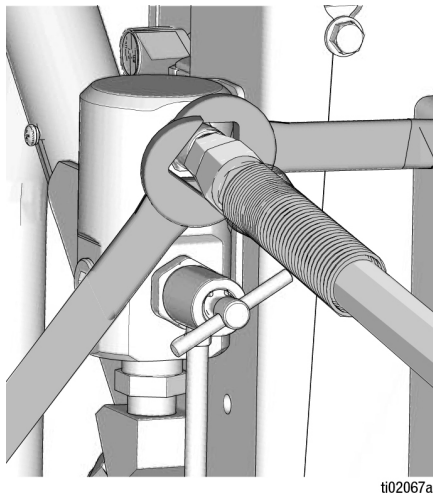

2. Connect other end of hose to gun.

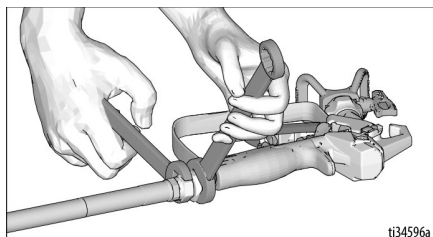

3. Use wrenches to tighten securely.

4. Engage trigger lock.

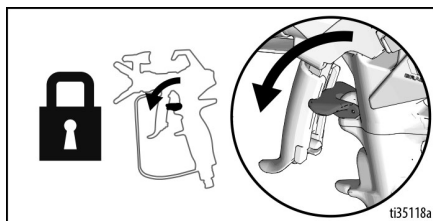

5. Remove tip guard.

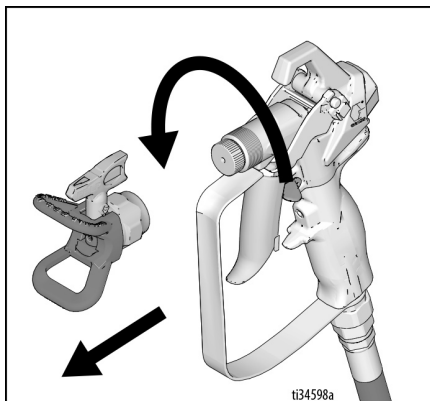

6. When unpacking sprayer for the first time, remove packaging materials from inlet strainer. After long time storage, check inlet strainer for clogs and debris.

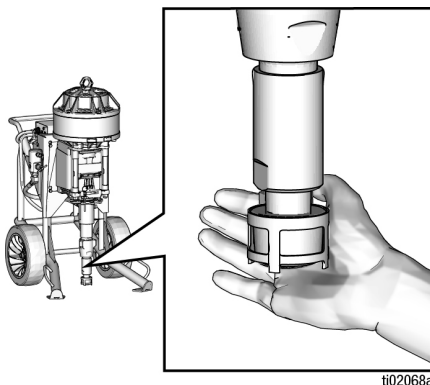

7. Fill throat packing nut with TSL to prevent premature packing wear. Do this daily or each time you spray.

- a. Place the TSL bottle nozzle into the opening in the grill at the front of the sprayer.

SETUP

- b. Squeeze bottle to dispense enough TSL to fill the space between the pump rod and packing nut seal.

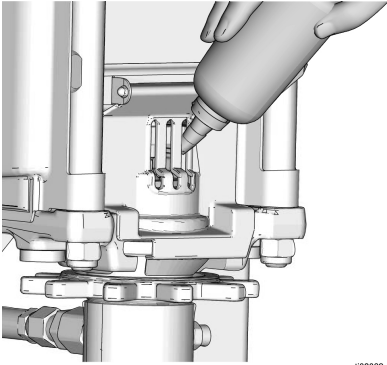

ti02069a

8. Make certain ON/OFF switch is **OFF**.

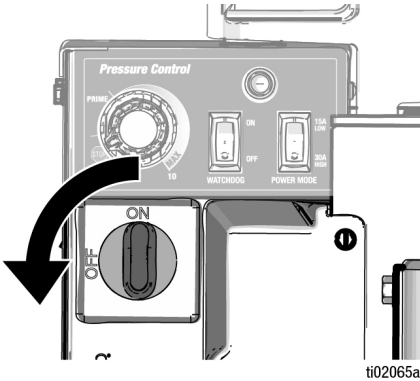

ti02065a

9. Plug power supply cord into a properly grounded electrical outlet.

10. Place fluid intake in grounded metal pail partially filled with flushing fluid. See the **Grounding** section in this manual.

NOTE:

New sprayers are shipped with storage fluid that must be flushed out with compatible solvent prior to using the sprayer. Check flushing fluid for compatibility with material that is to be sprayed. A secondary flush with a compatible fluid may be necessary.

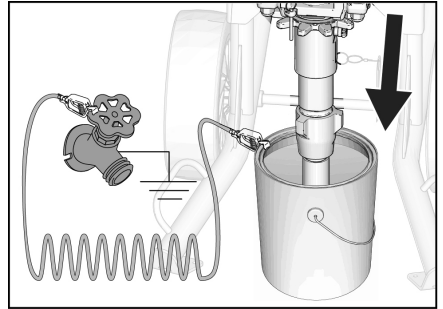

ti02070a

11. Turn pressure control **OFF**.
12. Turn ON/OFF switch to **ON** position.
13. Disengage trigger lock.
14. Hold a metal part of the gun firmly to a grounded metal pail. Trigger gun and turn pressure control up until the pump runs steady and flushing fluid appears. Trigger gun for 10-15 seconds.
15. Turn ON/OFF switch to **OFF** position.
16. Engage trigger lock.

Sprayer is now ready for startup and spray!

STARTUP











High-pressure spray is able to inject toxins into the body and cause serious bodily injury. Do not stop leaks with hand or rag.

- 1. Perform **Pressure Relief Procedure**.
- 2. Turn pressure control knob to **OFF** position.



- 3. Turn ON/OFF switch to **ON** position.

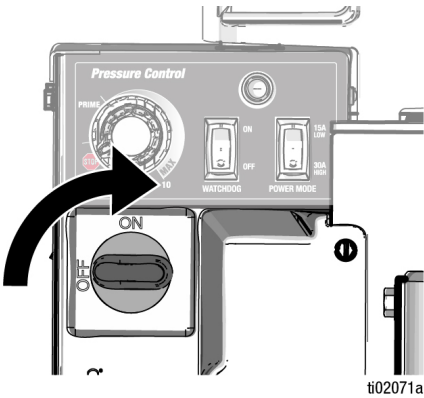

- 4. Prime through drain valve only if necessary.

NOTE:
Usually required for high viscosity materials.

NOTICE
Do not prime pump through drain/purge valve using two-component materials. Mixed two-component materials will harden in valve and result in clogging.

- a. Place drain tube in a grounded waste pail. Open drain/purge valve by slightly rotating counterclockwise.

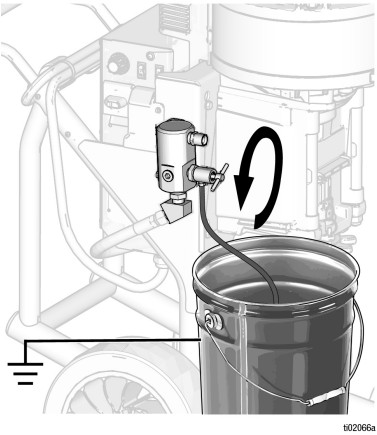

- b. Turn pressure control up until the pump runs steady.



5. Prime hose and gun. Trigger until pump begins to cycle and a steady stream comes from the gun. Trigger for 20 seconds. Engage trigger lock.



6. Inspect airless hose connections for leaks. If leaks occur, perform **Pressure Relief Procedure**, then tighten all fittings and repeat startup procedure. If there are no leaks, continue with the next steps.
7. With the trigger lock engaged, screw tip assembly onto gun and tighten. See **Spray Tip Installation** in this manual. For gun assembly instructions, see separate gun manual.

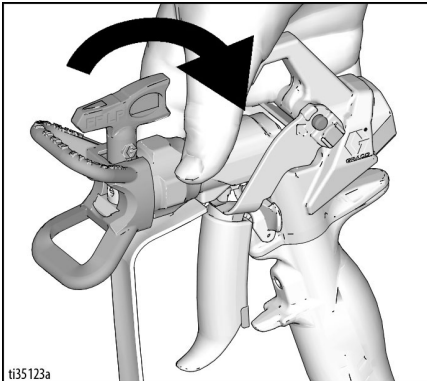

OPERATION

SPRAY TIP
INSTALLATION



WARNING

| | | | |
|--|---|---|---|
|  |  |  |  |
|--|---|---|---|

To avoid serious injury from skin injection, do not put your hand in front of the spray tip when installing or removing the spray tip and tip guard.

1. Perform **Pressure Relief Procedure**.
2. Use spray tip (A) to insert OneSeal™ (B) into tip guard (C).

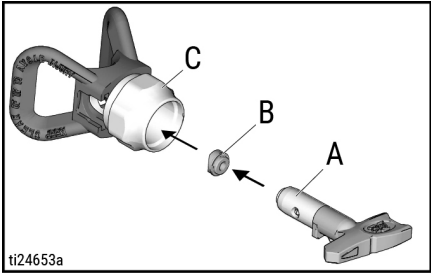

3. Insert spray tip.

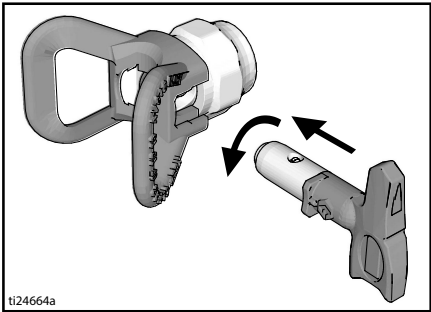

4. Screw assembly onto gun and tighten.

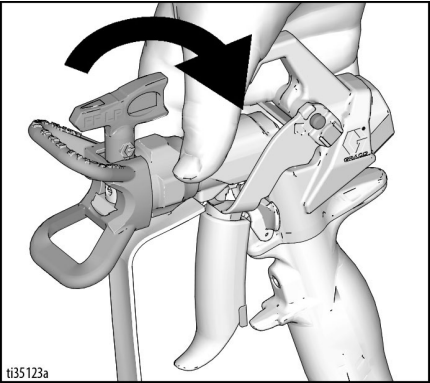

SPRAY

1. Spray test pattern. Adjust pressure to eliminate heavy edges.

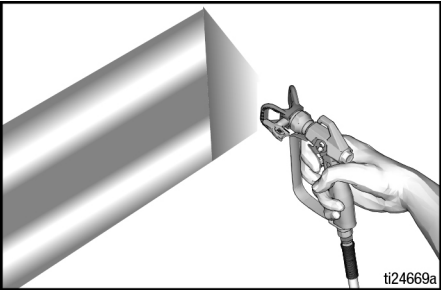

2. Use smaller tip size if pressure adjustment cannot eliminate heavy edges.

CLEAR SPRAY TIP CLOG CLEANUP





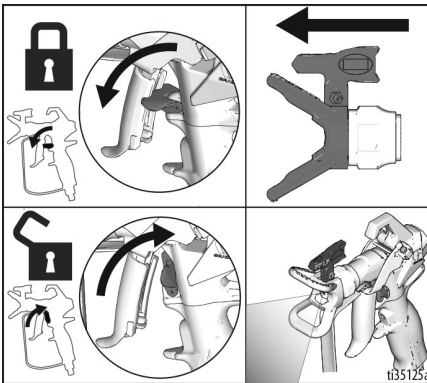

| ⚠ WARNING | | | | |
|--|---|---|--|--|
|  |  |  | | |
| To avoid injury, never point gun at your hand or into a rag! | | | | |

1. Release trigger. Engage trigger lock. Rotate spray tip. Disengage trigger lock. Trigger gun at waste area to clear clog.



2. Engage trigger lock. Return spray tip to original position. Disengage trigger lock and continue spraying.



| ⚠ WARNING | | | | |
|---|---|---|---|---|
|  |  |  |  |  |
|  | | | | |

1. Perform **Pressure Relief Procedure**.
2. Remove tip guard and spray tip. For additional information, see separate gun manual.

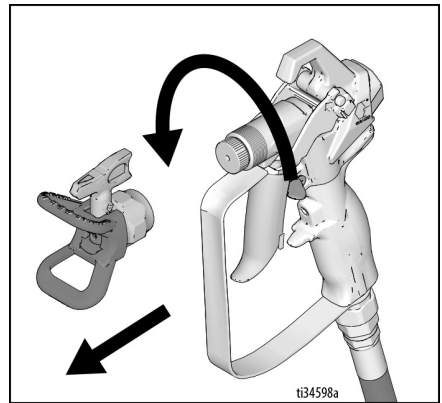

3. Place fluid intake in a compatible solvent.

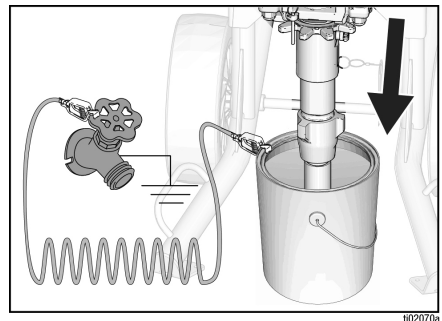

NOTE:

Do not stretch hose tight. Let it hand to assist fluid flow into the pump.

OPERATION

4. Hold gun against waste pail. Disengage trigger lock. Trigger gun and turn pressure control up until the pump runs steady and flushing fluid appears in the waste pail.



5. Stop triggering gun.

6. If the sprayer was primed using the drain/purge valve, or the drain/purge valve was used to relieve pressure at any time during operation:

- a. Place drain tube in a grounded waste pail. Open fluid drain/purge valve slightly by rotating counterclockwise.

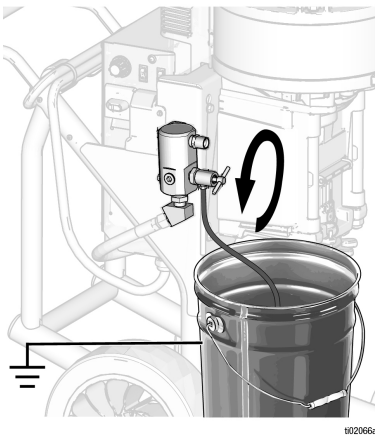

- b. Turn pressure control up until the pump runs steady and flushing fluid appears in the waste pail.

- c. When clean solvent flows from drain tube, close fluid drain/purge valve by rotating clockwise. Pump will stall.

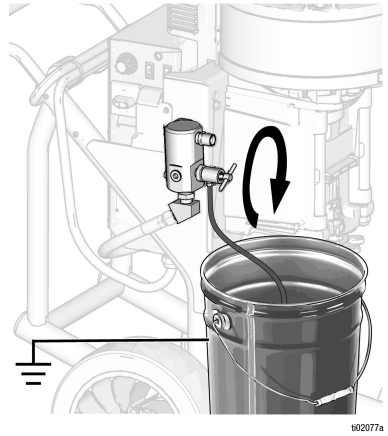

7. Turn pressure control knob (B) to PARK. In PARK, pump will cycle until reaching the bottom of the stroke.



8. Perform **Pressure Relief Procedure**.

WATCHDOG

The Watchdog™ Pump Protection System automatically shuts down the pump when material runs out of it the suction tube is damaged.

To enable Watchdog, turn Watchdog switch to **ON** position.

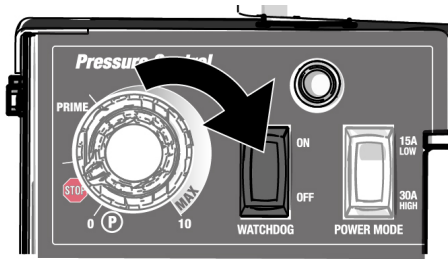

ti02072a

MAINTENANCE

Routine maintenance is important to ensure proper operation of your sprayer. Maintenance includes performing routine actions which keep your sprayer in operation and prevents trouble in the future.



Perform **Pressure Relief Procedure** before performing maintenance.

Table 9-1: Maintenance Schedule

| ACTIVITY | INTERVAL |
|---|-------------------------------|
| Flush Procedure. | Daily or each time you spray. |
| Fill TSL by adding through TSL fill port. | Daily or each time you spray. |
| Throat packing adjustment. When pump packing begins to leak after extended use, tighten packing nut until leakage stops or lessens. | As necessary. |
| Clean suction tube using a compatible solvent. | Daily or each time you spray. |

END OF PRODUCT LIFE

At the end of the product's useful life, dismantle and recycle it in a responsible manner.

- Perform **Pressure Relief Procedure**.
- Drain and dispose of fluids according to applicable regulations. Refer to the material manufacturer's Safety Data Sheet.
- Remove motors, batteries, circuit boards, LCDs (liquid crystal displays), and other electronic components. Recycle according to applicable regulations.
- Do not dispose of electronic components with household or commercial waste. 
- Deliver remaining product to a recycling facility.

MECHANICAL / FLUID
FLOW

WARNING







To help prevent serious injury from pressurized fluid, such as skin injection, splashing fluid, and moving parts, follow the **Pressure Relief Procedure** when you stop spraying and before cleaning, checking, or servicing the equipment.

Keep clear of moving parts during troubleshooting procedures.

1. Follow **Pressure Relief Procedure** before checking or repairing.
2. Check all possible problems and causes before disassembling the unit.

Table 11-1: Troubleshooting

| PROBLEM | CAUSE | SOLUTION |
|---------------------|---|---|
| Pump output is low. | Spray Tip is worn. | Replace Spray Tip. See separate Gun or Spray Tip manual. |
| | Spray Tip is clogged. | Clear Spray Tip. See Clear Spray Tip Clog . |
| | Material supply low. | Refill and reprime pump. |
| | Intake strainer clogged. | Remove and clean, then reinstall. If problem persists, strain the paint. |
| | Intake vavle ball and piston ball are not seating properly. | Remove intake valve and clean. Check balls and seats for nicks; replace if necessary. See pump manual. Strain paint before using the remove particles that could clog pump. |
| | Verify pump does not continue to stroke when gun trigger is released (prime valve not leaking). | Service pump. See pump manual. |
| | Leaking around throat packing nut which may indicate worn or damaged packings. | Tighten packing nut/wet-cup. Replace packings. See pump manual. Also check piston valve seat for hardened paint or nicks and replace is necessary. |
| | Pump rod damage. | Repair pump. See pump manual. |

TROUBLESHOOTING

| PROBLEM | CAUSE | SOLUTION |
|-------------------|--|---|
| | Piston packings are worn or damaged. | Replace packings. See pump manual. |
| | O-ring in pump is worn or damaged. | Replace o-ring. See pump manual. |
| | Large pressure drop in hose with high viscosity materials. | Reduce overall length of hose. Use larger diameter hose. |
| | Amp switch is on low setting. | Switch to high power mode. |
| Pump loses prime. | Leak in suction tube. | Replace suction tube. |
| | Debris stuck in inlet ball. | Remove foot valve and clean with appropriate cleaning solution. |

ERROR CODE TROUBLESHOOTING

NOTE:

The blink code is displayed using the LED indicator (C) on the driver. The blink code given below indicates the sequence. For example, blink code 2 indicates two red blinks, a pause, and then repeats.

NOTE:

To clear an error code, first try turning the pressure adjustment knob (B) counterclockwise until it stops. If the status indicator (C) does not stop blinking red shortly after turning the knob to zero, cycle the power by turning the power switch (A) to the OFF position for at least 30 seconds before turning back ON.

Table 11-2: Error Code Table

| CODE | MESSAGE | ACTION |
|------|--|---|
| 02 | Code 02-High pressure detected | Relieve pressure. Check for clogs in filters and hoses. Use minimum of 50 ft (15 m) of Graco hose. Check transducer. |
| 03 | Code 03-Pressure transducer not detected | Turn sprayer OFF and unplug sprayer. Remove shroud. Check transducer cable and connection to control board. Check transducer. |
| 04 | Code 04-Multiple incoming voltage surges detected. | Turn sprayer OFF and unplug the sprayer. Locate good voltage supply to prevent damage to electronics. |
| 05 | Code 05-Motor not spinning due to high mechanical load | Turn sprayer OFF and unplug the sprayer. Attempt to spin motor. Motor should spin freely. If motor doesn't spin freely, remove pump and re-check by spinning motor again. If motor spins easily, check control board. |
| 06 | Code 06-Motor thermal protection enabled | Keep sprayer plugged in and allow time to cool. This may take up to an hour. Check vents in bottom and top of sprayer for blockage. If applicable, check fan connector and wiring, fan should be running. Unplug sprayer and check to make sure the motor spins freely. |
| 08 | Code 08-Incoming voltage too low for sprayer operation | Turn sprayer OFF and unplug the sprayer. Locate good voltage supply to prevent damage to electronics. |
| 09 | Code 09-Communication to encoder failed | Turn sprayer OFF , unplug sprayer and wait five minutes. Remove shroud. Check cables and connections. Check motor. |

TROUBLESHOOTING

| CODE | MESSAGE | ACTION |
|------|---|---|
| 10 | Code 10-Control board thermal protection enabled | Keep sprayer plugged in and allow time to cool. This may take up to an hour. Check vents in bottom and top of sprayer for blockage. If applicable, check fan connector and wiring, fan should be running. Unplug sprayer and check to make sure the motor spins freely. |
| 12 | Code 12-Excessive current protection enabled | Cycle power ON and OFF . If problem persists, check motor. |
| 15 | Code 15-Motor not spinning, no motor current detected | Turn sprayer OFF , unplug sprayer and wait five minutes. Remove shroud. Check cables and connections. Check control board. Check motor. |
| 17 | Code 17-Control board plugged into wrong voltage | Turn sprayer OFF and unplug the sprayer. Locate good voltage supply to prevent damage to electronics. |

Figure 12-1: King E-Max XT Parts Diagram

Table 12-1: King E-Max XT Parts List

| REF. | PART | DESCRIPTION | QTY. |
|------|------|--------------------------|------|
| | | | |
| | | | |
| | | | |
| | | | |
| | | | |
| | | | |
| | | | |
| | | | |
| | | | |
| | | | |
| | | | |
| | | | |
| | | | |
| | | | |
| | | | |
| | | | |
| | | | |
| | | | |
| ▲ | | Replacement Safety Label | 1 |

▲ Replacement safety labels, tags, and cards are available at no cost.

CALIFORNIA PROPOSITION 65

CALIFORNIA RESIDENTS



WARNING Cancer and reproductive harm — www.P65warnings.ca.gov.

GRACO STANDARD WARRANTY

Graco warrants all equipment referenced in this document which is manufactured by Graco and bearing its name to be free from defects in material and workmanship on the date of sale to the original purchaser for use. With the exception of any special, extended, or limited warranty published by Graco, Graco will, for a period of twelve months from the date of sale, repair or replace any part of the equipment determined by Graco to be defective. This warranty applies only when the equipment is installed, operated and maintained in accordance with Graco's written recommendations.

This warranty does not cover, and Graco shall not be liable for general wear and tear, or any malfunction, damage or wear caused by faulty installation, misapplication, abrasion, corrosion, inadequate or improper maintenance, negligence, accident, tampering, or substitution of non-Graco component parts. Nor shall Graco be liable for malfunction, damage or wear caused by the incompatibility of Graco equipment with structures, accessories, equipment or materials not supplied by Graco, or the improper design, manufacture, installation, operation or maintenance of structures, accessories, equipment or materials not supplied by Graco.

This warranty is conditioned upon the prepaid return of the equipment claimed to be defective to an authorized Graco distributor for verification of the claimed defect. If the claimed defect is verified, Graco will repair or replace free of charge any defective parts. The equipment will be returned to the original purchaser transportation prepaid. If inspection of the equipment does not disclose any defect in material or workmanship, repairs will be made at a reasonable charge, which charges may include the costs of parts, labor, and transportation.

THIS WARRANTY IS EXCLUSIVE, AND IS IN LIEU OF ANY OTHER WARRANTIES, EXPRESS OR IMPLIED, INCLUDING BUT NOT LIMITED TO WARRANTY OF MERCHANTABILITY OR WARRANTY OF FITNESS FOR A PARTICULAR PURPOSE. Graco's sole obligation and buyer's sole remedy for any breach of warranty shall be as set forth above. The buyer agrees that no other remedy (including, but not limited to, incidental or consequential damages for lost profits, lost sales, injury to person or property, or any other incidental or consequential loss) shall be available. Any action for breach of warranty must be brought within two (2) years of the date of sale.

GRACO MAKES NO WARRANTY, AND DISCLAIMS ALL IMPLIED WARRANTIES OF MERCHANTABILITY AND FITNESS FOR A PARTICULAR PURPOSE, IN CONNECTION WITH ACCESSORIES, EQUIPMENT, MATERIALS OR COMPONENTS SOLD BUT NOT MANUFACTURED BY GRACO. These items sold, but not manufactured by Graco (such as electric motors, switches, hose, etc.), are subject to the warranty, if any, of their manufacturer. Graco will provide purchaser with reasonable assistance in making any claim for breach of these warranties.

In no event will Graco be liable for indirect, incidental, special or consequential damages resulting from Graco supplying equipment hereunder, or the furnishing, performance, or use of any products or other goods sold hereto, whether due to a breach of contract, breach of warranty, the negligence of Graco, or otherwise.

FOR GRACO CANADA CUSTOMERS The Parties acknowledge that they have required that the present document, as well as all documents, notices and legal proceedings entered into, given or instituted pursuant hereto or relating directly or indirectly hereto, be drawn up in English. Les parties reconnaissent avoir convenu que la rédaction du présente document sera en Anglais, ainsi que tous documents, avis et procédures judiciaires exécutés, donnés ou intentés, à la suite de ou en rapport, directement ou indirectement, avec les procédures concernées.

GRACO INC. AND SUBSIDIARIES | P.O. BOX 1441 | MINNEAPOLIS MN 55440-1441 | USA

Graco Headquarters: Minneapolis, MN USA | International Offices: Australia, Belgium, China, Japan, Korea | Toll Free Phone Number: 1-800-690-2894 (Contractor Division) and 1-800-328-0211 (Industrial Division) | For patent information, see graco.com/patents

©2025 Graco Inc. All written and visual data in this document are based on the latest product information available at the time of publication. Graco reserves the right to make changes at any time without notice. All Graco manufacturing locations are registered to ISO 9001. Original Instructions. This manual contains English. Revision A, February 2025



APPLICATION FAST SET

483 Avenue Lazare Ponticelli
77220 Gretz-Armainvilliers
Tel : 01 64 16 41 63 - Fax : 01 64 16 48 67
contact@afs-bicomposant.fr
www.afs-bicomposant.fr